

ME 8260

ASSEMBLY INSTRUCTION

REMOVE ALL ITEMS FROM THE CARTON . VERIFY ALL PIECES BEFORE ASSEMBLY.

PART'S LIST

KEY	QTY	DESCRIPTION	KEY	QTY	DESCRIPTION	KEY	QTY	DESCRIPTION
1	5	CASTER	6	1	SEAT CUSHION	11	1	SET RIGHT AND LEFT ARM
2	1	BASE	7	5	SCREW 1/4" X 3/4"	12	1	ALLEN WRENCH
3	1	SEAT POST	8	15	SMALL WASHER			
4	1	SEAT POST COVER	9	11	SCREW 1/4" X 1"			
5	1	SEAT PLATE	10	1	BACK CUSHION			

STEP 1.

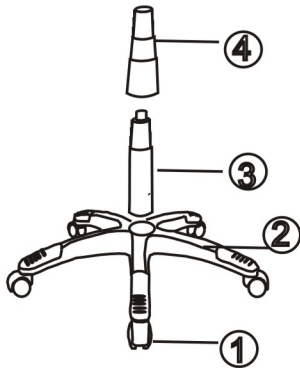

STEP 2.

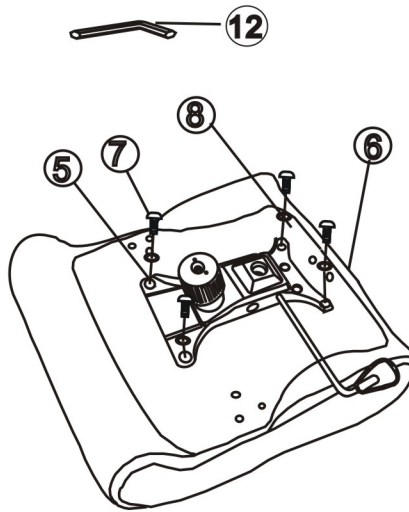

STEP 3.

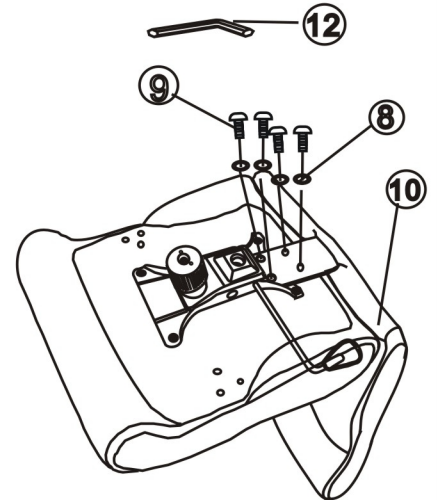

STEP 4.

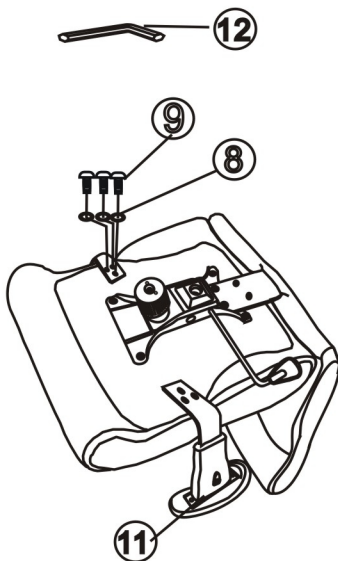

STEP 5.



STEP 6.



PREVENTIVE MAINTENANCE AND WARNING

- USE THIS PRODUCT ONLY FOR SEATING ONE PERSON AT A TIME.
- DO NOT USE CHAIR AS STEP STOLL/LADDER.
- DO NOT USE CHAIR UNLESS ALL BOLTS, SCREWS ARE TIGHT. AT LEAST EVERY SIX MONTHS, CHECK ALL BOLTS, SCREWS TO BE SURE THEY ARE TIGHT.
- IF ANY PARTS ARE MISSING, BROKEN, DAMAGED OR WORN, STOP USE OF THE PRODUCT UNTIL REPAIRS ARE MADE USING FACTORY AUTHORIZED PARTS.
- FAILURE TO FOLLOW THESE WARNINGS CAN RESULT IN SERIOUS INJURY.