

PolyVision®

User Guide

Part number 370-0255-01
©2009 PolyVision Corporation
All rights reserved

Information in this document is subject to change without notice.
Reproduction in any manner without written permission of PolyVision Corporation is forbidden.

PolyVision is a registered trademark of Steelcase, Inc. Walk-and-Talk and Lightning are trademarks of PolyVision Corporation. Webster is a registered trademark of PolyVision Corporation.

This product is covered by one or more of the following patents:
Canada 2,100,624; EPO 600,576; EPO 871,935; Germany
69,321,445; WO 98/14888; US 4,777,329; US 5,248,856; US
5,327,161; US 5,434,370; US 5,583,323; US 5,585,605; US
5,623,129; US 5,665,942; US 5,790,114; US 5,838,309 US
6,353,193; US 6,355,895; US 6,445,384; US 6,667,739; Other
patents pending.

PolyVision Corporation reserves the right to make changes in product design, or detail, and to discontinue any product or material without notice.

Flash™ Player, Shockwave® Player, and Authorware® Player are owned by Adobe Systems.

Table of contents

Welcome	1
What are Walk-and-Talk products?	1
What are TS products?	2
Basics	3
How it works.	3
Operating Walk-and-Talk products	4
Using the remote control	4
Remote control options	4
Remote control functions	6
Using multiple Walk-and-Talk products	9
Using Walk-and-Talk products with multiple monitors	10
Operating the TS Interactive Whiteboards	10
About writing and erasing	12
Writing and erasing on WT and WTL whiteboards	12
Writing and erasing on TS and TSL whiteboards	13
Writing and erasing with CL and IP models	14
About printing and saving	16
About printing	16
About saving	16
Projection mode	17
Getting started in projection mode	18
Choosing alignment accuracy	19
About writing in projection mode	19
Writing notes next to a projected image	20
Marking-up computer projections	20
Choosing mark-up pen styles	21
Erasing mark-ups	21
Cursor control in projection mode	22
Spotlight and reveal options	23
Spotlighting your work	23
Revealing your work	23
Printing and saving mark-ups	24
Using the on-screen keyboard	24
The PolyVision driver	26

System requirements	26
Driver installation for Walk-and-Talk models	27
Driver installation for TS models	27
Configuring PolyVision driver options.	28
General options	29
Save options	29
Draw options	30
Print options	30
Projection options	31
Hardware options	31
Using the on-screen remote control	33
Getting help	33
Checking for updates	33
Using Webster	34
Quitting the PolyVision driver.	34
To uninstall the PolyVision driver in Windows.	34
To uninstall the PolyVision driver on a Macintosh.	35
Using Walk-and-Talk Wireless (IR)	36
Using the TS Wireless option (IR)	38
Important considerations.	38
Transceiver LEDs	39
Establishing a wireless link	40
When a wireless link breaks	40
Re-establishing a broken link	40
Troubleshooting the wireless (IR) option	41
Using the BT (Bluetooth) option	43
Registering the whiteboard in Windows.	43
Registering the whiteboard on a Macintosh.	45
Confirming Bluetooth registration	45
FCC identification	46
Technical support	47

Welcome

Congratulations on your purchase of a sleek and simple solution for interactivity with your computer. This manual describes the PolyVision® Walk-and-Talk and TS devices that operate with the PolyVision driver running on your computer.

What are Walk-and-Talk products?

Walk-and-Talk products are remote control-operated systems that interact with your computer. You can capture a snapshot of anything you write or project by pressing Print or Save on the remote control. Your digital snapshot prints on the default printer connected to your computer, or it is saved as a file on your computer, just as a digital image from a camera would be.



This manual describes how to use these Walk-and-Talk products:

- Walk-and-Talk interactive whiteboard (WT)
- Walk-and-Talk Lightning™ interactive whiteboard (WTL)
- Walk-and-Talk Interactive Panel (IP)
- Walk-and-Talk Cordless Lectern (CL)

With the PolyVision driver installed on your computer and your computer connected to a projector, your Walk-and-Talk product becomes a touch-screen monitor for your computer. (The CL and IP models always operate this way.) You can control your computer the using your finger (or the stylus for CL and IP models), or you can roam freely about the room and operate your computer using the remote control touch pad and buttons.

Walk-and-Talk interactive whiteboards (WT and WTL) include two wireless options. The Walk-and-Talk Wireless option provides infrared wireless communication between your interactive whiteboard and your computer. (Refer to “Using Walk-and-Talk Wireless (IR)” on page 36.) The Walk-and-Talk BT option provides Bluetooth wireless communication between your interactive whiteboard and your computer. (Refer to “Using the BT (Bluetooth) option” on page 43.)

Refer to separate manuals for information about installing these products.

What are TS products?

PolyVision’s TS (touch sensitive) interactive whiteboards enable you to capture a snapshot of anything you write or project by tapping the Print or Save icon along the edge of the board. Your digital snapshot prints using the default printer connected to your computer or it is saved as a file on your computer, just as a digital image from a camera would be.

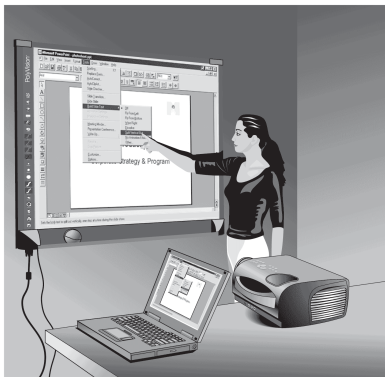

With the PolyVision driver installed on your computer and your computer connected to a projector, you have the ability to operate your computer using the TS whiteboard as a touch screen. You can operate your computer from the board using your finger and touch-sensitive icons along the edge of the board.

This manual describes these TS products:

- TS Interactive Whiteboard (TS)
- TS Lightning Interactive Whiteboard (TSL)

TS whiteboards include two wireless options. The TS Wireless option provides infrared wireless communication between your interactive whiteboard and your computer. (Refer to “Using the TS Wireless option (IR)” on page 38.) The TS BT option provides Bluetooth wireless communication between your TS 600 model whiteboard and your computer. (Refer to “Using the BT (Bluetooth) option” on page 43.)

Refer to separate manuals for information about installing these products.

Basics

The PolyVision driver that is installed on the computer connected to your PolyVision product enables you to save or print whatever you see written or projected onto your PolyVision device.

How it works

To get started using your Walk-and-Talk or TS interactive device:

1. Make sure it is plugged in and turned on, if necessary.
2. Make sure the PolyVision driver is installed on the computer connected to the Walk-and-Talk or TS interactive device. If not, refer to “Driver installation for Walk-and-Talk models” on page 26.
3. Choose a pen or stylus, if necessary. (Refer to “About writing and erasing” on page 12.)
4. Write or draw on the PolyVision product. (Refer to “About writing and erasing” on page 12.)
5. To erase, choose an eraser tool and erase. (Refer to “About writing and erasing” on page 12.)
6. To print a copy using the printer connected to the computer, tap the Print icon (TS models) or press Print on the remote control (Walk-and-Talk models). (Refer to “About printing and saving” on page 16.)
7. To save a copy as a file on the computer, tap the Save icon (TS models) or press Save on the remote control (Walk-and-Talk models). (Refer to “About printing and saving” on page 16.)
8. To project your computer on the Walk-and-Talk or TS interactive device and gain the powerful features of projection mode, press the Projection button on the remote (Walk-and-Talk models) or tap the Projection icon (TS models). (Refer to “Projection mode” on page 17.)

NOTE:

The Walk-and-Talk CL and IP always operate in projection mode.

Operating Walk-and-Talk products

Using the remote control

You control your Walk-and-Talk whiteboard, cordless lectern, or interactive panel using a remote control. The Walk-and-Talk remote control operates at a distance of up to 40 feet (12 m) from any of the Walk-and-Talk products.

When your computer is projected on the Walk-and-Talk product, the remote control enables you to roam freely about the room while you give your presentation. Use the remote control to move the computer cursor, click and double-click, and launch an on-screen keyboard to enter text into dialog boxes. The remote control also has buttons that enable you to print or save a snapshot of your presentation.

Always point the remote control toward the infrared receiver in your Walk-and-Talk product: at the top of the interactive whiteboard, or at the remote control receiver that comes with your interactive panel or cordless lectern.

Remote control options

The remote control functions equally well from these locations:

- Carry the remote control with you using the wrist or neck lanyard provided.
- Place the remote control near you on a desk or table top pointed toward the infrared receiver.
- In Projection mode, project an on-screen remote control that you use by tapping the buttons with your finger or stylus. (Refer to “Using the on-screen remote control” on page 33)

NOTE:

If you are using a TS interactive whiteboard, a touch-sensitive icon strip along the edge of the board functions in place of the Walk-and-Talk remote control. Refer to “Operating the TS Interactive Whiteboards” on page 10.

Remote control functions

Erase All

Erase everything and start fresh. All writing, in dry-erase marker or projection mark-up, is erased from memory.

Ink Color

To write on the board, choose a dry-erase pen and press the button that matches the color. In projection mode, press one of these buttons to quickly change the color of mark-ups.

Print

Print a snapshot of the board using the default printer connected to your computer.

Save

Save a snapshot of your board as a file on your computer. The file can be in PDF, JPEG, TIFF, PNG, BMP and other formats.



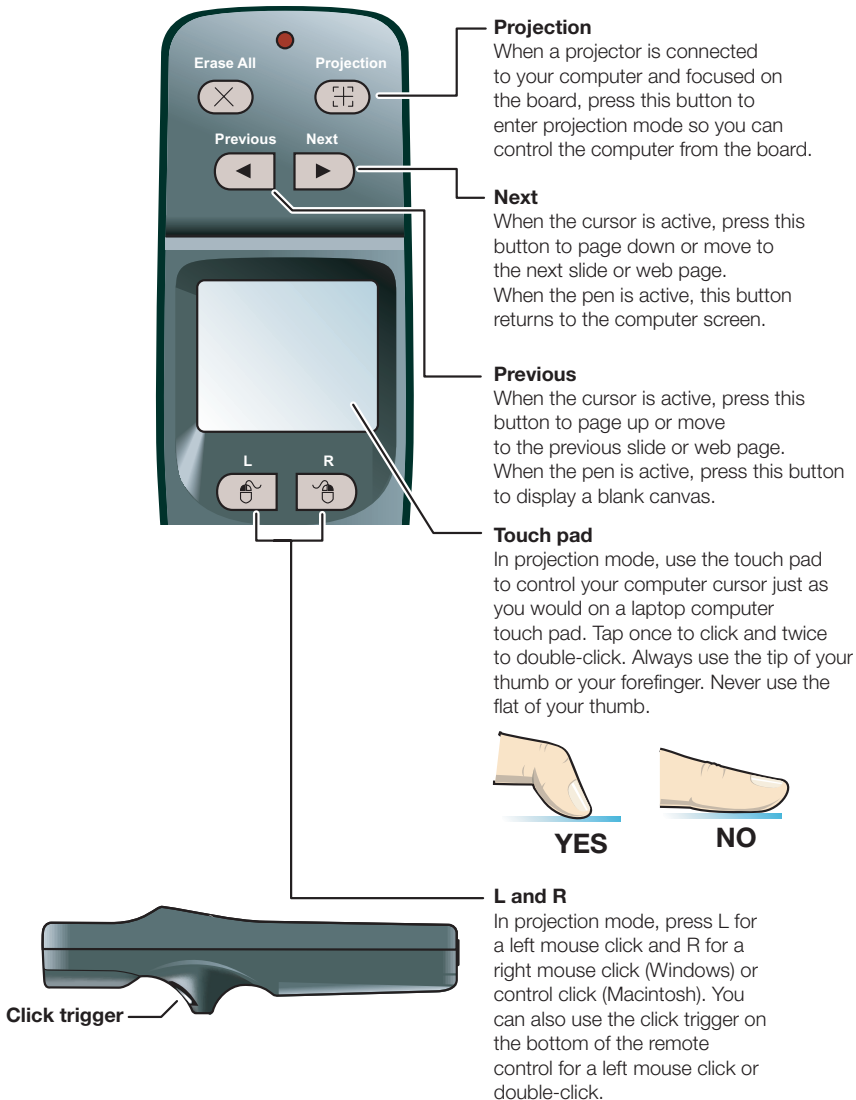

Cursor/Pen

In projection mode, press this button to toggle between controlling the cursor and marking-up the image.

Pen Style

Press this button in projection mode to choose a new type of mark-up pen (color, width, and style).

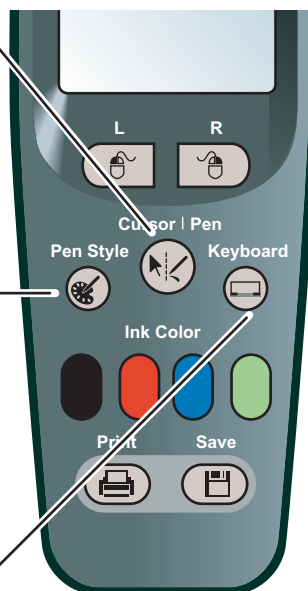

Keyboard

In projection mode, press this button to toggle on and off the display of the on-screen keyboard. You can use the keyboard to enter text at the current text cursor position. Drag the keyboard to move it.

Using multiple Walk-and-Talk products

If your room includes multiple Walk-and-Talk products, you can operate up to three of them with the same computer and remote control. Multiple devices can be associated with the same computer, but multiple computers cannot be associated with one device.

One remote control can operate up to three Walk-and-Talk products connected to your computer, but only one at a time. To determine which product is active, the remote control includes a three-position switch on the left side.



Three-position switch (A/B/C)

By default, your Walk-and-Talk product responds to the remote control whether it is set to A, B, or C. However, if you use multiple Walk-and-Talk products with the same remote control, you must assign one remote control switch position to each device.

To use multiple devices:

1. Connect the devices to your computer's USB ports.
2. Click the PolyVision driver icon in the system tray (Windows) or the system menu bar (Macintosh).
3. Choose "Configure the PolyVision driver" from the menu.
4. Click the "Hardware" tab.
5. Click "Change Remote ID."
6. Slide the switch on the remote to position "A."
7. Point the remote to one device and click "Projection."
8. Repeat for up to two additional devices connected to your computer, choosing the "B" and "C" switch positions on the remote control.

When a device has been assigned the A, B, or C position on the remote control switch, it remains associated with that switch position until you change the connections to your USB ports, even if you re-boot your computer or attach the Walk-and-Talk product to another computer.

Using Walk-and-Talk products with multiple monitors

The PolyVision driver supports up to three projectors on the same computer showing separate parts of the computer's desktop. You may need to add an additional video card(s) to use multiple projectors.

Since all the PolyVision products connected to your computer are communicating via the PolyVision driver, you have the option of pointing the remote at the active device or at the most convenient of the communicating devices.

To use the remote control with multiple devices:

1. Write or project a computer display on any or all of the connected devices.
2. To capture a snapshot or use other remote control functions, slide the switch to the position that matches the device you want to capture or operate.
3. Point the remote to any of the Walk-and-Talk products and press the desired button. Any of the connected devices can receive infrared commands from your remote, but the function will take place only on the device that is associated with the remote control.



















Snapshots that you save on your computer with multiple products connected continue to be numbered sequentially, regardless of which product is captured.

Each PolyVision product operates independently, so device "A" can capture a red marker while device "B" captures a blue marker.

Operating the TS Interactive Whiteboards

The TS and TSL Interactive Whiteboards include a touch-sensitive icon strip along the edge of the board that provides the same functions as the Walk-and-Talk remote control.

TS icon Operation

	Toggles “projection mode” on and off. The first use starts the onscreen alignment (calibration) process.
	Goes to the previous PowerPoint slide or PgUp.
	Goes to the next PowerPoint slide or PgDown.
	Displays the on-screen keyboard.
	Toggles between writing and cursor control.
	Displays all pen size and color options.
	The current pen color for writing on the board.
	
	
	
	
	The current pen width.
	Sets the pen to a solid line.
	Sets the pen to a dashed line.
	Small eraser width using the pen.
	Large eraser width using the pen.
	Clears all the writing.
	Prints a copy of the whiteboard.
	Saves a copy of the whiteboard.

About writing and erasing

The PolyVision device sends writing and erasing data to your computer by detecting a single point of pressure. Whenever you write on the PolyVision device, make sure there is only one point of contact at a time.

The tool you use to write on your PolyVision device depends upon which model you have.

NOTE:

Use only the recommended markers, stylus, and erasers.

NOTE:

For TS, TSL, WT or WTL whiteboard users: The whiteboard's surface can be damaged by sharp objects, such as ballpoint pens and rulers. Scratches can cause permanent ink stains and data loss due to electrical malfunctions.

Writing and erasing on WT and WTL whiteboards

The Walk-and-Talk whiteboard models (WT and WTL) are touch sensitive and send writing data to your computer by detecting a single point of pressure. Use standard dry-erase markers to write on the board. To specify the color that is recorded in the software, press the corresponding ink color button on the remote control.

To write on the board so you can save or print:

1. Choose a dry-erase marker.
2. Press one of the ink color buttons on the remote control to specify the color that is recorded in the software.
3. Write on the board.

When you choose a pen color and write, sounds from the board provide audible feedback to confirm that the software is recording. A selected pen color (or eraser) stays in effect until you select a different one.

While you write, the red “Ink Recorded” LED glows to indicate that the computer is detecting your writing.

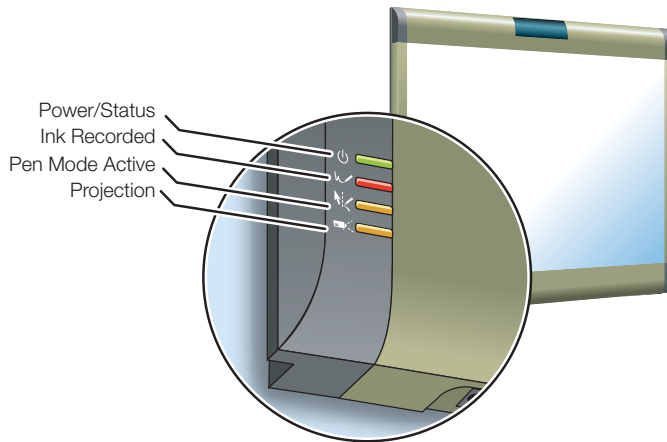

Erase the board using the large circular felt eraser provided. The battery-operated eraser sends infrared data to the computer through the whiteboard.

Refer to “About writing in projection mode” on page 19 for information about writing when your computer screen is projected on the whiteboard.

Writing and erasing on TS and TSL whiteboards

The PolyVision TS and TSL whiteboards are touch sensitive and send writing data to your computer by detecting a single point of pressure. Use standard dry-erase markers to write on the board.

To write on the board so you can save or print:

1. Choose a dry-erase marker.
2. Tap one of the pen color icons on the board to specify the color that is recorded in the software.
3. Write on the board.

The active pen color is indicated by the LED next to the pen color icon on the board. The default pen color recorded in the software is black. To change the default color at startup, refer to “Configuring PolyVision driver options” on page 28.

When you choose a pen color and write, sounds from the board provide audible feedback to confirm that the software is recording. A selected pen color (or eraser) stays in effect until you select a different one.

Erase the board using the large circular felt eraser provided, or using your finger for small erasures.

To record erasures for printing or saving:

- Tap the Small or Large Eraser icon on the board before you erase.

Refer to “About writing in projection mode” on page 19 for information about writing when your computer screen is projected on the whiteboard.

Writing and erasing with CL and IP models

The Walk-and-Talk Cordless Lectern (CL) and Interactive Panel (IP) send data to your computer by detecting the battery-operated stylus as you write or erase across the panel. The stylus can act as a mouse to control the computer cursor or as a pen to mark-up the projected computer screen. Do not use dry-erase markers with these products.

To toggle between writing and cursor control:

- Press the Cursor/Pen button on the remote control.

To specify the color for writing:

1. Press the Pen Style button on the remote control. A palette of options appears in the display screen.
2. Tap one of the pen styles in the palette options. The palette closes.

To erase:

1. Press the Pen Style button on the remote control. A palette of options appears in the display screen.
2. Tap the small or large eraser. The palette closes.
3. Erase using the stylus.

To erase everything you have written or drawn:

- Press the Erase All button on the remote control.

A selected pen color (or eraser) stays in effect until you select a different one.

About printing and saving

The PolyVision driver enables the Walk-and-Talk and TS interactive products to capture your notes by printing them or saving them as a file on your computer.

About printing

You can print an image of what you see displayed at any time using the default printer connected to the computer.

To print:

- Walk-and-Talk models: Press Print on the remote control.
- TS or TSL whiteboards: Tap the Print icon on the whiteboard.

The PolyVision product sends the image to the default printer on your computer.

About saving

The PolyVision driver on your computer enables you to save an image of the everything you see on the screen, including writing and your projected computer screen in projection mode (refer to “Projection mode” on page 17.) You can specify the type and location of the saved image file in the PolyVision driver configuration options (refer to “Configuring PolyVision driver options” on page 28).

To save an image of the display screen:

- Walk-and-Talk models: Press the Save button on the remote control.
- TS or TSL whiteboards: Tap the Save icon on the whiteboard.

Projection mode

While using your PolyVision product in projection mode, with a projector connected to your computer, a variety of powerful options become available.

In projection mode, the PolyVision interactive product becomes a touch-sensitive monitor for your computer. You can:

- Control your computer from the touch-sensitive screen. For Walk-and-Talk products, you can also roam freely about the room and interact with the computer using the remote control.
- Run slide presentations and other software from the PolyVision display screen instead of the computer.
- Make notes and drawings over your computer's projected screen that you can print or save.

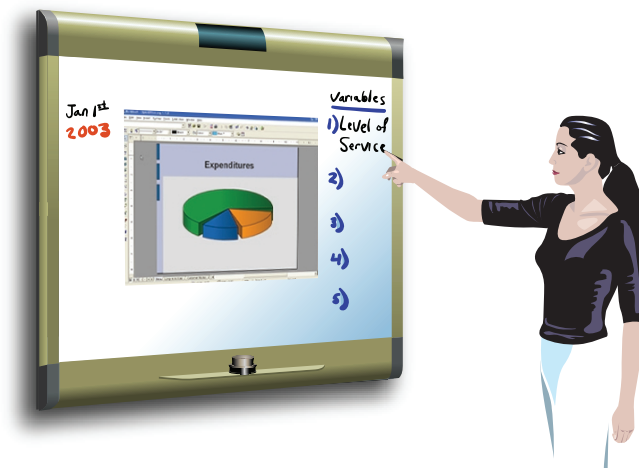

Projection mode is an option for Walk-and-Talk interactive whiteboards (WT and WTL) and TS whiteboards (TS and TSL), but the Walk-and-Talk cordless lectern (CL) and interactive panel (IP) always operate in projection mode.

Getting started in projection mode

Cable connections between your computer and the projector enable you to control your computer from the interactive whiteboard or using the remote control (WT and WTL).

NOTE:

At startup, the PolyVision driver recognizes if you are using the CL or IP and automatically initiates projection mode. No alignment is necessary.

To enter projection mode:

1. Connect your computer to the projector and turn on the projector, the whiteboard, and the computer.
2. **WTL or TSL whiteboards:** Assure that at least half of the projected image is actually projected onto the board.
WT or TS whiteboards: Move the projector physically so that the entire solid-colored background is positioned inside the borders of the whiteboard.
3. Press the “Projection” button on the remote control (Walk-and-Talk models) or tap the Projection icon on the board (TS models) one time. The following alignment window projects from the computer to the board.



4. Using your finger, touch each target as it appears, following instructions you see in the screen.

When alignment is complete, you are ready to begin using your computer and whiteboard in projection mode.

NOTE:

WT or WTL whiteboards: The Projection LED at the lower left corner of the board glows yellow while you are in projection mode.

To exit projection mode:

- Press the Projection button on the remote control (Walk-and-Talk products) or tap the Projection icon (TS whiteboards).

Choosing alignment accuracy

The alignment between your projector and the PolyVision product is important. PolyVision offers three levels of alignment: good, better, best. The default is “better” alignment.

You might need to use more alignment points to improve the correspondence between the position of the computer cursor and the point of contact when you tap the PolyVision product. (Some video projectors, for instance, do not produce a linear display when projection with keystone correction is used.)

To change the number of alignment points:

1. Click the PolyVision driver icon in you computer system menu bar or system tray (refer to “Configuring PolyVision driver options” on page 28).
2. Click the “Projection” tab.
3. Choose an alignment type from the drop-down list.

Proceed as usual to enter projection mode or re-align while in projection mode. Follow the alignment instructions that are projected on your product.

About writing in projection mode

In projection mode, interactive whiteboards (WT WTL, TS, or TSL) provide two types of writing:

- writing on the whiteboard using dry-erase markers
- marking up the projected computer screen using your finger for computer-projected “ink.”

For CL and IP models, you use with the stylus for all writing. (Refer to “Marking-up computer projections”).)

Writing notes next to a projected image

With an interactive whiteboard (WT, WTL, TS, or TSL) while in projection mode you can use a dry-erase marker to write notes on the whiteboard, as usual, and print or save everything you see, including any writing with the dry-erase marker, the computer projection, and mark-ups (refer to “Marking-up computer projections”).

Marking-up computer projections

While in projection mode, you can draw, highlight, and write over the projected computer screen. This type of writing is called “mark-up” and it is part of the projected image, not physical ink.

To mark-up the projected computer image:

1. Press the “Cursor/Pen” button on the remote control (Walk-and-Talk models) or tap the “Pen/Cursor” icon on the board (TS models). The cursor changes from an arrow to a pen. (To return to mouse operations, press “Cursor/Pen” on the remote or tap the “Pen/Cursor” icon on the board again.)



2. Write over the projected computer image using your finger (or the stylus for CL or IP models).

To quickly change the color of markups:

- Walk-and-Talk products: Press the black, red, blue, or green “Ink Color” button on the remote control.

- TS products: Tap the black, red, blue, or green icon on the board.

Choosing mark-up pen styles

While marking-up the projected computer image, you can choose from 54 unique pen styles (six colors, three line widths, and three dash styles) plus three highlighter pen colors and two mark-up eraser widths.

To change your mark-up pen style:

1. Press the Pen Style button on the remote control (Walk-and-Talk models) or tap the Pen Style icon (TS models). A palette of options appears.

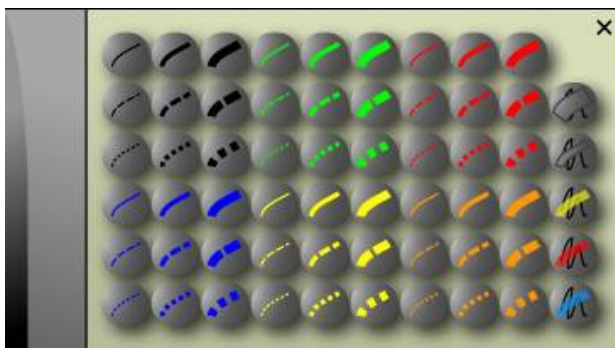

2. To change the pen style, tap an option in the palette. The palette closes when you tap a pen style option and the new pen style appears in future mark-ups.
3. To move the palette, drag it with your finger.
4. To close the palette without changing pen style, you can either tap the “close” button at the upper corner of the palette, tap anywhere on the screen, press the Pen Style button on the remote control (Walk-and-Talk models) or tap the Pen Style icon (TS models), or begin writing with a dry-erase marker outside the projected computer screen.

Erasing mark-ups

Your mark-ups remain available until you erase them.

To erase mark-ups that you want deleted from saved or printed images:

- WT or WTL whiteboards only: Erase with the circular battery-operated eraser provided.
- TS models: Tap the Large or Small Eraser icon on the board and erase with your finger or the eraser provided.
- CL or IP models: Choose the small or large eraser option in the Pen Style palette and erase with your finger or the stylus.
- Press the “Erase All” button on the remote control (Walk-and-Talk products) or “Erase All” icon (TS products) to erase everything on the screen and start fresh.

Cursor control in projection mode

PolyVision products display your projected computer image and enable you to control your computer using:

- your finger (WT, WTL, TS or TSL interactive whiteboard models)
- the remote control (Walk-and-Talk models)
- the stylus (CL or IP models)

When you want to control your computer, always touch the display screen inside the borders of the projected computer image:

- To click, tap the display once.
- To double-click, tap the display twice rapidly.
- For a right-click (Windows) or control-click (Macintosh), hold your finger to the display for one second.

With the remote control (Walk-and-Talk models), you can roam freely about the room and control the projected computer screen. To operate your computer with the remote control, point it toward the infrared receiver on the Walk-and-Talk product:

- To click or double-click, press the “L” button or the click trigger once or twice, or tap once or twice on the remote control touch pad.
- For a right-click (Windows) or control-click (Macintosh), press the “R” button.

- To page up or down through a document, press the “Next” or “Previous” button (for example, if PowerPoint is the active window, press “Next” to move to the next slide).

For CL or IP models, control your computer from the screen using the stylus provided:

- To click, tap the display once.
- To double-click, tap the display twice rapidly or hover the stylus over the display and press the stylus button furthest from the tip.
- For a right-click (Windows) or control-click (Macintosh), hold the stylus to the display for one second, or hover the stylus over the display and press the stylus button near the tip.

When using the stylus provided with IP models, the stylus does not need to touch the display. It operates when the stylus is hovering within an inch or so of the display.

Spotlight and reveal options

The red “Ink Color” button on the remote control (Walk-and-Talk products) or “Red Pen” icon (TS products) has three optional functions which you can configure:

- red pen color for writing
- spotlight
- reveal

Spotlighting your work

To use the spotlight:

1. Configure the red pen for the spotlight option. Refer to “Projection options” on page 31.

2. Press the red “Ink Color” button on the remote control (Walk-and-Talk products) or “Red Pen” icon (TS products). The screen becomes grayed except one circle of light.

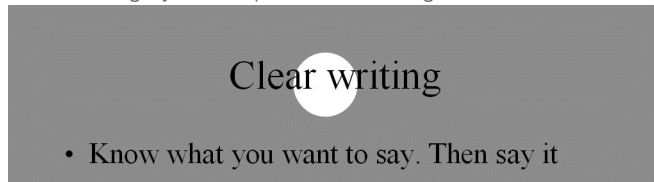

3. Drag the spotlight around the screen to focus attention on that portion of the screen.
4. To re-shape the spotlight into an ellipse, drag the circle from any of the four cardinal points around the edge of the circle.

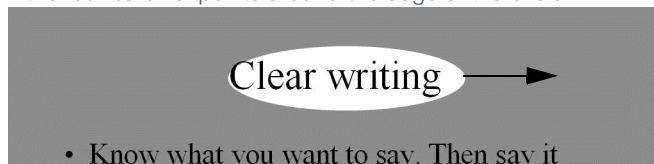

5. To enlarge or shrink the circle, drag it from any point around the edge except the four cardinal points.

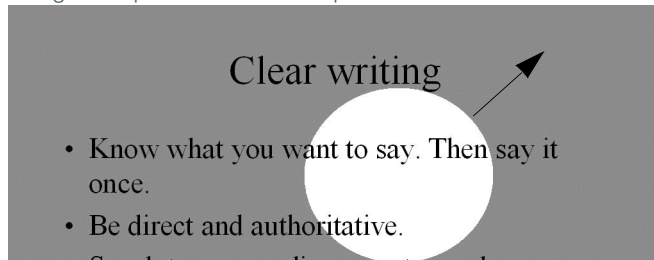

To remove the spotlight:

- Press the red “Ink Color” button on the remote control (Walk-and-Talk products) or “Red Pen” icon (TS products) again.

Revealing your work

To use the reveal tool:

1. Configure the red button for the reveal option. Refer to “Projection options” on page 31.

1. Press the red “Ink Color” button on the remote control (Walk-and-Talk products) or “Red Pen” icon (TS products). The projected screen becomes black except one strip at the top.

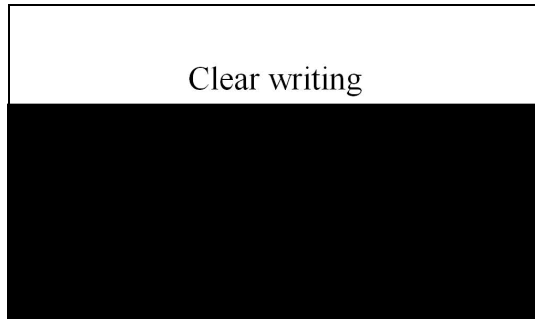

2. Drag the strip down to reveal more of the screen.

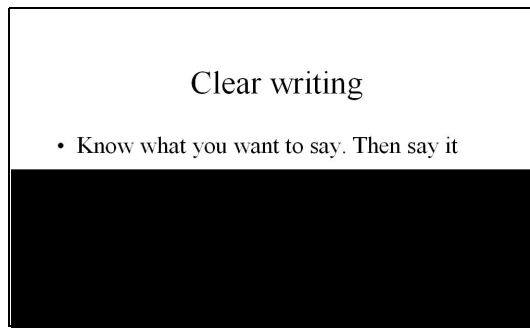

To reveal the entire projected screen and continue your presentation:

- Press the red “Ink Color” button on the remote control (Walk-and-Talk products) or “Red Pen” icon (TS products) again.

If you prefer to write on a clean display, you can change to a blank canvas to continue writing.

To display a blank canvas for mark-ups:

- Press the “Previous” button on the remote control.

To return to the projected computer image:

- Press the “Next” button.

Printing and saving mark-ups

You can capture snapshots that include your computer screen and the mark-ups you added. Mark-ups leave no ink, but they are part of the snapshot.

To capture a snapshot of the display:

- Press the Print or Save button on the remote control (Walk-and-Talk models) or the Print or Save icon on the board (TS models).

Using the on-screen keyboard

In projection mode, PolyVision products provide quick access to your operating system's on-screen keyboard so you can enter text in a dialog box or other projected computer window as an alternative to typing from your computer's keyboard. Macintosh requires that the keyboard is enabled before it can be recognized by the PolyVision driver.

To use the on-screen keyboard:

1. Press the Keyboard button on the remote control or icon strip. The on-screen keyboard appears.



2. Tap the board to place the cursor where you want to enter text.
3. To enter text, tap keys on the on-screen keyboard.
4. To move the keyboard, drag the title bar to another location.
5. To close the keyboard, tap the "close" button at the upper corner of the window or choose Keyboard on the remote control Walk-and-Talk models) or icon strip (TS models).

The PolyVision driver

The PolyVision driver for your Walk-and-Talk or TS products is always available and running in the background after you install it on your computer.

System requirements

Your Windows-based computer must have:

- Windows 2000, XP, Tablet XP, or Vista
- VGA HD-15 video port for projectors or interactive panels
- One USB port (two for the interactive panel)

Your Macintosh computer must have:

- PowerPC G3 or higher or Intel-based processor
- Mac OS 10.2 or higher
- VGA HD-15 video port for projectors or interactive panels
- One USB port (two for the interactive panel)

Driver installation for Walk-and-Talk models

The PolyVision driver is always close at hand. You need no installation disk or CD-ROM. Installing the PolyVision driver takes place when you connect the PolyKey on the Walk-and-Talk USB cable to your computer's USB port.

To install the PolyVision driver on your computer:

1. Locate the PolyKey on the USB cable.

2. Connect the PolyKey on the USB cable to your computer's USB port.

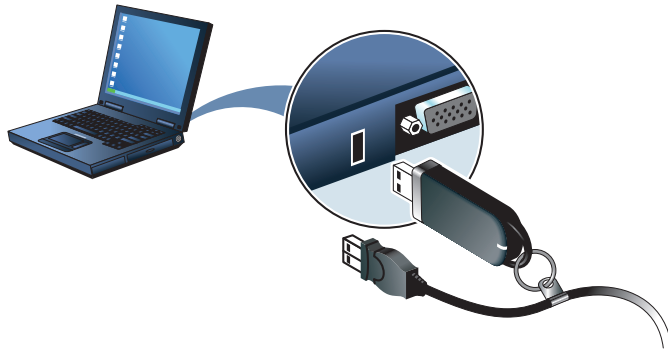

3. Installation should begin automatically. If it does not:
Windows: double-click "My Computer" on your desktop and double-click the removable disk drive named "PolyKey." Installation begins.
Macintosh: double-click the PolyKey icon on your desktop, double-click the Macintosh folder, and double-click "PolyVision driver installation." Installation begins.
4. Follow the prompts you see on the screen to complete the installation. On a Macintosh, you must re-boot your system.

When installation is complete, a message appears on your computer screen and the PolyVision driver icon appears in your system tray (Windows) or system menu (Macintosh).

To start using your PolyVision interactive products:

1. Disconnect the PolyKey.

2. Connect the USB cable to your computer's USB port and the other cable end to the PolyVision product.

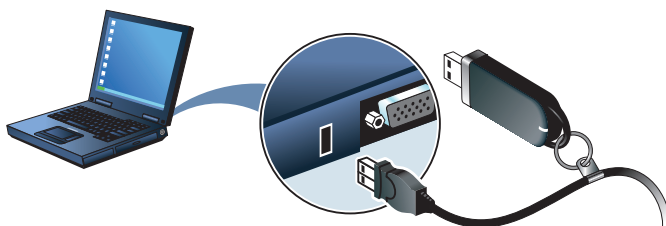

The PolyVision driver runs unobtrusively in the background whenever your computer is on and connected to the PolyVision interactive product.

If you are using the Walk-and-Talk wireless option, refer to “Using Walk-and-Talk Wireless (IR)” on page 36. If you are using the WT BT (Bluetooth) option, refer to “Using the BT (Bluetooth) option” on page 43.

Driver installation for TS models

To install the PolyVision driver:

1. Locate the installation CD provided with your whiteboard.
2. Insert the CD into your computer disk drive.
3. Installation should begin automatically. If it does not:
Windows: double-click “My Computer” on your desktop, double-click the disk drive named “PolyVision,” double-click the Windows folder, and double-click “PolyVision driver installation.” Installation begins.
Macintosh: double-click the PolyVision icon on your desktop, double-click the Macintosh folder, and double-click “PolyVision driver installation.” Installation begins.
4. Follow the prompts you see on the screen to complete the installation. On a Macintosh, you must re-boot your system.

When installation is complete, a message appears on your computer screen and the PolyVision driver icon appears in your system tray (Windows) or system menu (Macintosh).

If you are using the TS wireless option, refer to “Using the TS Wireless option (IR)” on page 38. If you are using the TS 600 BT (Bluetooth) option, refer to “Using the BT (Bluetooth) option” on page 43.

Configuring PolyVision driver options

The PolyVision driver is ready to use as soon as it is installed. However, you can change the default options at any time.

To configure PolyVision driver options:

1. Click the PolyVision driver icon in the system tray (Windows) or system menu bar (Macintosh).

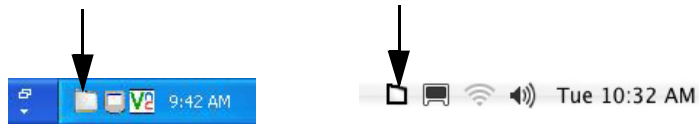

2. The PolyVision driver menu appears.

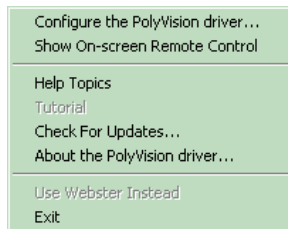

3. Choose “Configure the PolyVision driver.” The Configure Options dialog box appears. (Shown below on the left for Macintosh users and on the right in Windows.)

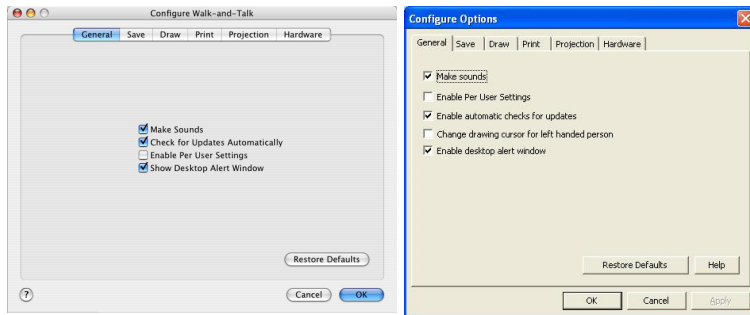

4. Options are organized in tabs. Each tab includes these buttons:
 - “**Help**”: Click “Help” (Windows) or “?” (Macintosh) to view help information.
 - “**OK**”: Click “OK” to save your changes and close the dialog box.
 - “**Apply**”: Click “Apply” (Windows) to save your changes and leave the dialog box open.
 - “**Cancel**”: Click “Cancel” to close the dialog box and make no changes to options.
 - “**Restore Defaults**”: Click “Restore Defaults” to restore factory defaults.

General options

To configure general options:

- Click the “General” tab. You see the following options:

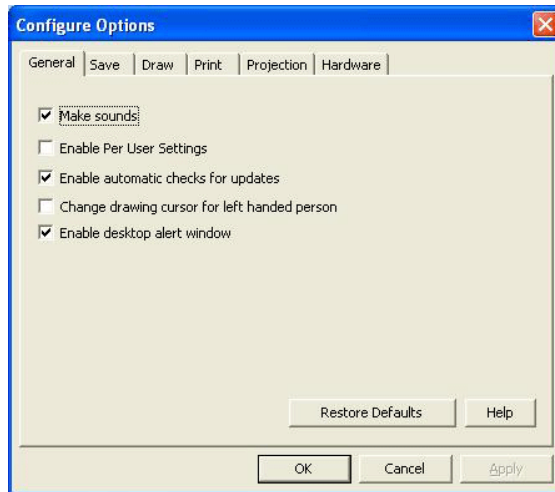

“Make sounds”: Check this box to enable sounds as you press buttons on the remote, or sounds that indicate system status.

“Enable Per User Settings”: Check this box to save settings so they apply to individual users who connect to this board. When this box is unchecked, settings apply to all users.

“Enable automatic checks for updates”: Check this box if you want the PolyVision driver to connect automatically to the PolyVision web site and check for driver updates.

“Change drawing cursor for left handed person”: (Windows only) Switches the cursor for ease-of-use for left-handed users.

“Enable desktop alert window”: Check this box if you want to see an alert window appear on your computer desktop while you write or draw on the device. The alert window shows what you are drawing. As soon as you stop drawing, the window fades off.

Save options

To configure Save options:

- Click the “Save” tab. You see these options:

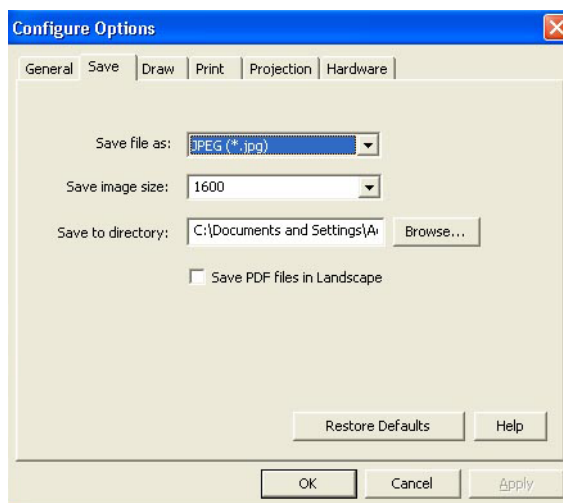

“Save File As”: Specify the format of the snapshot file saved on your computer when you press “Save” on the remote control. Options include PDF, JPEG, TIFF, PNG, or BMP. In Windows, you can also save as GIF. On a Macintosh, you can also save as PICT, Photoshop, SGI, TGA, and Quicktime Image formats. By default, snapshot files are saved in JPEG format (Windows) or PDF (Macintosh). If you save PDF files, you can save them in portrait or landscape orientation. To save PDF files in landscape orientation, check the **“Save PDF files in landscape”** box.

“Save image size”: Specify the width (in pixels) of the image that is created when you save. (The height is automatically determined by your whiteboard size.) Options include 2048, 1600, 1024, 800, and “Monitor Resolution” which saves images set to the width of your monitor.

“Save to Directory”: Specify the directory where snapshot files are saved. Click “Browse” to locate a directory. By default, snapshot files are saved to your “My Documents” (Windows) or “Documents” (Macintosh) folder.

Draw options

To configure pen options:

- Click the “Draw” tab. You see these options:

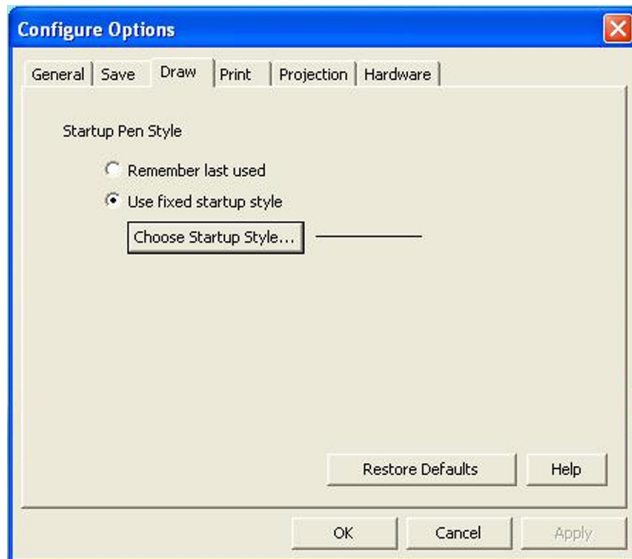

“Startup Pen Style”: To specify the pen style that is used when you start up the PolyVision driver on your computer, check “Remember Last Used.” Otherwise, click “Choose Startup Style.” The factory default pen style is a medium black line.

Print options

To configure print options:

- Click the “Print” tab. You see these options:

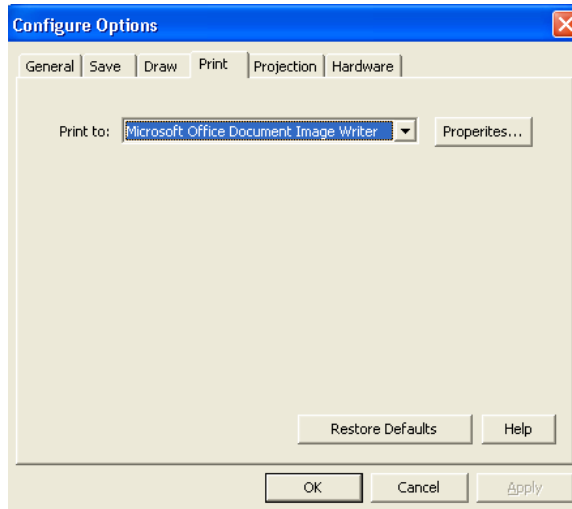

“Print To”: Specify the printer used when you press the “Print” button on the remote control. In Windows, the drop down list includes printers currently installed on your computer and you can click “Properties” to specify options for the selected printer. By default, your system default printer is used.

Projection options

To configure projection alignment options that apply when your device enters projection mode:

- Click the “Projection” tab. You see these options:

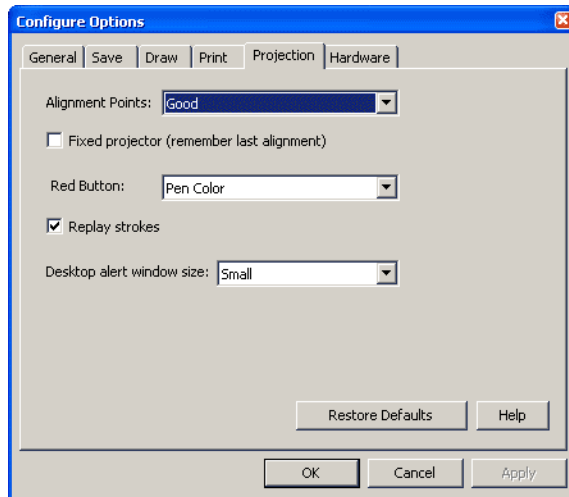

“Alignment Points”: Choose between three levels of projection alignment: good, better, and best. The more points you choose, the more accurately the cursor will be controlled from the whiteboard in projection mode. (This option is not necessary for Walk-and-Talk Lightning Interactive Whiteboards.)

“Fixed projector (remember last alignment)”: If your whiteboard and projector remain in the same positions, check this box to use the same projection alignment each time. No alignment screen displays when you enter projection mode if this box is checked.

“Red Button”: Choose an option from the drop-down list to reassign the function of the remote control button for drawing with red ink. Options are: “Pen Color” for drawing with red ink; “Spotlight” for focusing attention on one part of the screen using a spotlight that you can drag around the screen; or “Reveal” for gradually revealing screen contents from top to bottom. Refer to “Marking-up computer projections” on page 20.

“Replay Strokes”: When you check this box, pen strokes are remembered when you switch from pen mode to cursor mode, and back to pen mode. Pen strokes accumulate until you erase all.

“Desktop alert window size”: If you have enabled the desktop alert window in the Configure Options “General” tab, you can choose between a large or small alert windows size.

Hardware options

To configure hardware options:

- Click the “Hardware” tab. You see these options:

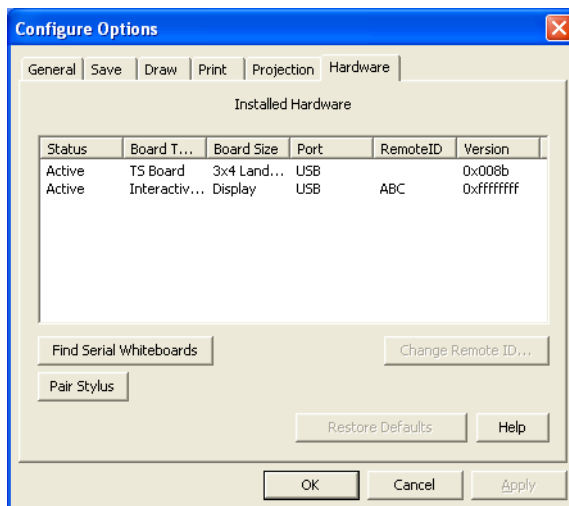

“Installed Hardware”: The communicating PolyVision products and their status appear in the list.

“Change Remote ID”: (Walk-and-Talk models only) Click this button to assign one of the remote control slide switch settings to a whiteboard. The slide switch has three positions corresponding to “A,” “B,” or “C.” If you choose “A,” “B,” or “C,” the selected board responds to the remote control when the slide switch on the remote is in the corresponding position. If you choose “A/B/C” the board responds regardless of the position of the slide switch on the remote control. (Refer to “Using multiple Walk-and-Talk products” on page 9.)

To assign a slide switch position to one of the installed whiteboards on a Macintosh, select a board in the “Installed Hardware” list then click “Change Remote ID” repeatedly to cycle through “A,” “B,” “C,” or “A/B/C” until your choice is displayed by the hardware. In Windows, select a Walk-and-Talk product in the “Installed Hardware” list then click “Change Remote ID.” You see this dialog box:

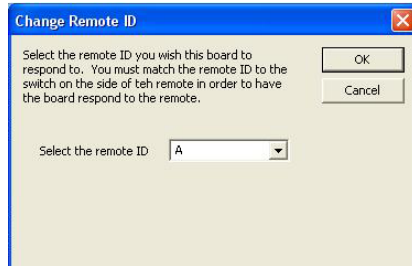

Select the desired remote ID from the drop-down list. The default is A/B/C.

“Find Serial Whiteboards”: If a PolyVision product is connected to your computer via the serial port, Walk-and-Talk Wireless, TS Wireless, WT BT (Bluetooth), or TS 600 BT (Bluetooth), click this button to confirm communication between the computer and the product. When you click “Find Serial Whiteboards” the PolyVision driver searches all attached boards and adds them to the list. Refer to “Using Walk-and-Talk Wireless (IR)” on page 36, “Using the TS Wireless option (IR)” on page 38, or “Using the BT (Bluetooth) option” on page 43.

Using the on-screen remote control

In projection mode, you can operate your interactive whiteboard product using an on-screen version of your remote control or icon strip.

To use the on-screen tool:

1. Click the PolyVision driver icon in the system tray (Windows) or system menu (Macintosh). The PolyVision driver menu appears.
2. Choose “Show On-Screen Remote Control” from the menu to toggle on and off the display of a functional on-screen tool.
3. **WT:** Tap the on-screen remote control buttons using your finger or the stylus. (The on-screen L and R buttons, and touch pad are non-functional.)

TS: Tap the on-screen icon strip.

Getting help

Choose “Help” from the PolyVision driver menu for information about using Walk-and-Talk products.

Checking for updates

PolyVision driver updates are available via the Internet. Registered users receive notice when updates are available. The PolyVision driver can check for updates automatically (refer to “General options” on page 29) or you can check for updates at any time.

To update the PolyVision driver:

1. Click the PolyVision driver icon in the system tray (Windows) or system menu bar (Macintosh). The PolyVision driver menu appears.
2. Choose “Check for Updates” from the menu when your computer is connected to the Internet. A system check reveals whether the version number available on the web agrees with the version installed on your system. If the version numbers are not the same, you can choose to initiate the download and automatic installation of the update. You can also enable automatic updates (refer to “General options” on page 29).

Using Webster

Webster[®] software is available from www.polyvision.com. If you would prefer to use the features of Webster instead of the ease and simplicity of the PolyVision driver, you can start Webster.

To use Webster software instead of the PolyVision driver:

1. Click the PolyVision icon in the system tray (Windows) or system menu bar (Macintosh). The PolyVision driver menu appears.
2. Choose “Open Webster” from the menu. Webster opens.
3. Choose “Find Whiteboard” from the Edit menu.
4. Select the PolyVision product that you want to use with Webster.

To return to using the PolyVision driver, quit Webster.

NOTE:

Only Webster versions 3.6 and higher are capable of sharing boards with the PolyVision driver. Check the PolyVision web site at www.polyvision.com for compatibility with your product.

Quitting the PolyVision driver

To shut down the PolyVision driver:

1. Click the PolyVision driver icon in the system tray (Windows) or system menu bar (Macintosh). The PolyVision driver menu appears.
2. Choose “Exit PolyVision driver” (Windows) or “Quit PolyVision driver” (Macintosh) from the menu. The PolyVision driver closes.

To resume capturing snapshots or operating the board using the remote control:

- **Windows:** choose “PolyVision driver” from the Start/Programs/PolyVision menu.
- **Macintosh:** double-click “PolyVision driver” in the Applications folder.

To uninstall the PolyVision driver in Windows

To uninstall the PolyVision driver in Windows:

1. Click “Start” at the lower left corner of the task bar.
2. Choose “Programs” from the menu.

3. Choose “PolyVision driver” from the menu.
4. Choose “Remove PolyVision driver.”

To uninstall the PolyVision driver on a Macintosh

You have two ways to uninstall the PolyVision driver on a Macintosh, based on whether you have access to the PolyKey. If you have access to the USB cable with the PolyKey:

1. Insert the PolyKey located at one end of the USB cable in the USB port of your computer.
2. Double-click the PolyKey icon that appears on the computer desktop.
3. Click “PolyVision Driver Installer.”
4. Use the “Uninstall” option.

If you do not have access to the USB cable and PolyKey, drag the following files to the Trash and then restart your computer:

1. Navigate to “Applications” and then to “PolyVision.”
2. Launch “PolyVision Driver Uninstaller.app.”
3. Follow the prompts as directed.

NOTE:

To delete these files, you need to enter an administrator password.

Using Walk-and-Talk Wireless (IR)

The Walk-and-Talk™ Wireless option provides infrared wireless communication between your interactive whiteboard (WT or WTL) and your computer.



Walk-and-Talk Wireless components replace the USB cable connection between your whiteboard and computer, giving you the freedom to position your computer up to 24 feet (7 m) away.

Infrared communication is designed to reflect from the ceiling and walls, enabling it to bounce over the heads of people writing on the board or sitting near the computer, so a direct line of sight between the board and the transmitter is not needed.

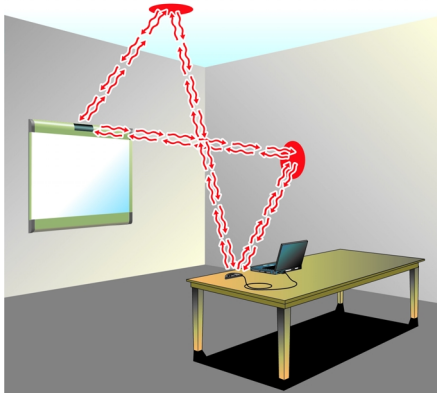

Hardware requirements:

- One serial port or one USB port and serial-to-USB adapter, available from PolyVision.

All Walk-and-Talk whiteboards, including Lightning models (WTL), require a power supply to work with Walk-and-Talk Wireless.

NOTE:

If you are using the wireless option with a WTL interactive whiteboard, be sure to connect the power supply provided with the wireless components to your board and to a power outlet.

The reflected infrared light can fill a standard size conference room or classroom to provide a very stable communication link between the board and your computer.

To establish a wireless communication link between the whiteboard and your computer:

1. Position the wireless transmitter so the curved edge faces the board.

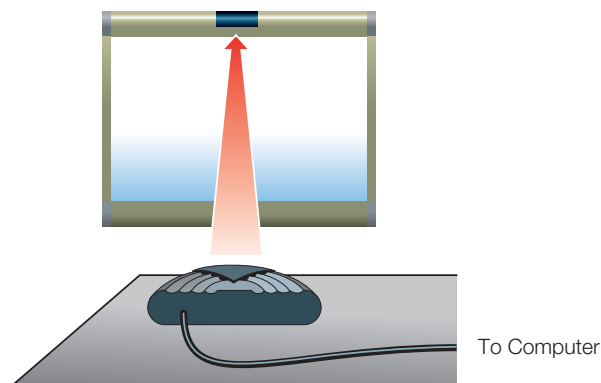

2. Adjust the position of the transmitter until the LED on it turns green.
3. If you are using the wireless option with a serial-to-USB adapter, install the software for the adapter first.

If you are connecting the wireless transmitter to the serial (COM) port on your computer, not using a serial-to-USB adapter, configure the PolyVision driver to communicate with your computer serial port as follows: click the PolyVision icon in your computer's system tray (Windows) or system menu (Macintosh), choose "Configure

PolyVision,” click the “Hardware” tab and click the “Find Serial Whiteboards” button. The PolyVision driver searches all serial ports for attached boards and adds them to the list. Select your board and click OK.

4. Test the wireless communication link by standing in front of the wireless transmitter. If the LED on the transmitter turns from green to amber, try moving the transmitter or other features in the room until the LED remains green even if someone stands in front of it. (Rooms with high ceilings or with few walls may require line-of-sight to operate Walk-and-Talk Wireless.)

Using the TS Wireless option (IR)

TS Wireless uses reflected infrared (IR) light to communicate between transceivers on your whiteboard and your computer. A direct line of sight between the transceivers is not needed for reliable communication. Both transceivers are designed to shine and detect IR light using the ceiling.

Install TS Wireless so both transceivers have an unobstructed view of the area of the ceiling between the two transceivers. This allows the IR from each transceiver to bounce over the heads of people writing on the board and sitting near the computer.

TS Wireless works best when the two transceivers are within 24 feet (7 m) of one another. The TS wireless option only works with TS interactive whiteboards.

Ceiling height and material also make a difference in performance. The higher the ceiling, the closer together the transceivers need to be. A non-IR reflective ceiling also reduces the range. The 24-foot (7 m) range assumes a typical office conference room with a ceiling height of between 8 and 12 feet (2.5 and 3.5 m) and a light-colored, acoustic tile ceiling. If your ceiling is not IR reflective, try using one of your walls. Do this by mounting one transceiver on the side of your whiteboard and pointing the other transceiver toward the wall on that side of the whiteboard.

Position the transceiver so the curved edge of the transceiver points toward the transceiver on the board.

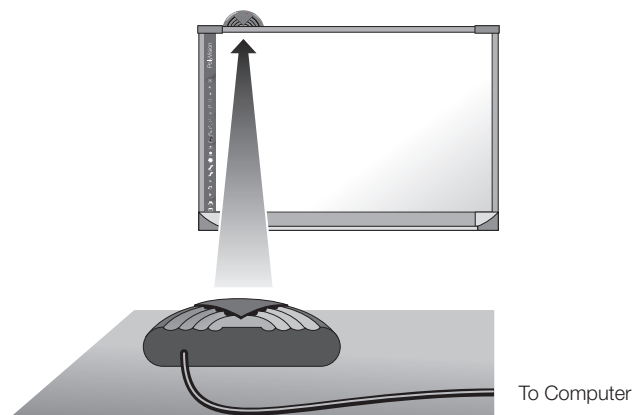

Adjust the position of the computer and whiteboard transceiver until both transceivers show a green light, then use the double-sided tape to fasten the whiteboard transceiver in place.

Once TS Wireless is installed and while a wireless link is established (green lights on both transceivers) most TS whiteboard systems function just as they did with the serial or USB cable in place.

Transceiver LEDs

The lights on both transceivers must be green for TS Wireless to work properly. It is possible for one transceiver to have a green light when the other transceiver only has an amber light. Be sure to check the lights on both transceivers before trying to use your whiteboard. It is also possible to have two green lights without the transceivers being plugged into the serial ports of the board or the computer and when either the board or the computer is not turned on.

Under certain circumstances the link breaks between TS Wireless transceivers. The light in the center of each TS Wireless transceiver tells you the current status:

OFF:	Transceiver is not receiving power.
AMBER:	Transceiver is receiving power.
GREEN:	Transceiver is receiving power and a signal from the other transceiver.

Establishing a wireless link

TS Wireless transceivers attempt to establish a wireless link automatically whenever they are powered on. Connecting power to a TS Wireless transceiver does two things:

- The transceiver starts sending out a signal that the other transceiver can receive.
- The transceiver starts looking for a signal from the other transceiver.

The green light comes on when the transceiver with the green light can see the signal from the other transceiver.

When a wireless link breaks

When the wireless link breaks:

- The light on one or both of the transceivers turns amber.
- Data stops flowing between your whiteboard and your computer.
- Your Webster software may give you an error message.

The Webster software error message can appear even when both transceiver lights are green. This means that one of the two transceivers has come unplugged from the serial connection on the board or the PC or that the board itself has lost power.

Re-establishing a broken link

It is possible to break the link in several ways. The two most obvious ways are to cover one of the transceivers or to unplug one of the transceivers from power. It is also possible to break the link by “shadowing” one of the transceivers. Because you can’t see IR light, you can’t see a shadow in the IR light being sent from one transceiver to another. A shadow usually occurs when a large object, like a person, is placed very close to one of the transceivers so it cannot see or bounce light off of the ceiling.

Remove the cause of the broken link and the link will automatically restore itself. The troubleshooting section gives you a list of symptoms, probable causes and cures for broken links.

Troubleshooting the wireless (IR) option

Problem	Cause	Solution
Both transceiver lights are GREEN, but your software says communication has been lost.	One or both ends of the serial cable is unplugged.	<ol style="list-style-type: none"> 1 Check the serial connections at both board and computer. 2 Some computers have multiple serial ports. Your whiteboard software may be trying to use a different serial port than the one your transceiver is connected to. Try connecting to a different serial port. 3 Try disabling other software that may be using the same com port, such as Palm HotSync.
One transceiver light is GREEN and the other is AMBER.	<ol style="list-style-type: none"> 1 The transceiver with the AMBER light is shadowed. 2 The transceiver with the GREEN light is blocked. 	<p>Move the AMBER transceiver away from any tall or overhanging objects such as computer monitors.</p> <p>Reposition the GREEN transceiver away from any tall or overhanging objects. If the board side transceiver is GREEN look for objects hanging from the ceiling above and in front of the transceiver such as drapes or signs.</p>
Both transceiver lights are AMBER.	The transceivers are too far apart or are shaded from one another.	<ol style="list-style-type: none"> 1 Move the transceivers closer together. 2 Move the transceivers out from under any overhanging objects. 3 Move the transceivers away from tall, wide objects that are between the two transceivers.

The light on one transceiver is OFF.	This transceiver has lost power.	<ol style="list-style-type: none">1 Check that the cord from the power supply is fully plugged into serial connector2 Check that the power supply is plugged into the wall.3 If a switch controls the wall plug, make sure the switch is on.
The connection keeps breaking and re-connecting while using the board.	Something moving in the room is periodically shadowing one of the transceivers. This is likely to be someone standing in front of the whiteboard, or walking in front of or sitting near the computer transceiver.	<p>On the whiteboard side, move the transceiver higher on the wall.</p> <p>On the computer side, move the transceiver away from any aisles or walkways. Particularly, move the transceiver away from any place where a person is likely to sit in front of the transceiver.</p>

Using the BT (Bluetooth) option

For Walk-and-Talk and TS 600 interactive whiteboards, the WT or TS Bluetooth® adapter from PolyVision® provides wireless Bluetooth communication between your computer and PolyVision interactive whiteboard.

Install the WT or TS 600 Bluetooth adapter first, then follow instructions for installing the whiteboard found in the **PolyVision Interactive Whiteboard Installation and Operation Guide**.

For Bluetooth wireless operation of a PolyVision interactive whiteboard, your computer must have Bluetooth capability and you must register the whiteboard's Bluetooth connection with your computer.

NOTE:

Instructions below describe registering the whiteboard's Bluetooth connection with your computer using Bluetooth software provided with Windows. If you installed an adapter made by another company on your computer to add Bluetooth capability, the menus and Wizards may differ. Be sure to connect any needed Bluetooth adapter to your computer and install the adapter software on your computer before you connect the TS Bluetooth adapter to the whiteboard and apply power to the whiteboard.

Registering the whiteboard in Windows

For each whiteboard (WT, WTL, or TS 600) that you want to share wireless Bluetooth communication with your computer, you must register the whiteboard with your computer.

To register a whiteboard for wireless communication with a Windows-based PC:

1. Right click the Bluetooth icon in your Windows taskbar.



You see the following menu. (Remember, if you use Bluetooth software not provided by Windows, your menu may differ.)



2. Choose "Add a Bluetooth Device" from the menu. You see the dialog box shown below.



3. Make sure that the whiteboard Bluetooth adapter is connected and the whiteboard is powered on.
4. Check "My device is set up and ready to be found."

5. Click “Next.” You see the dialog box shown below.

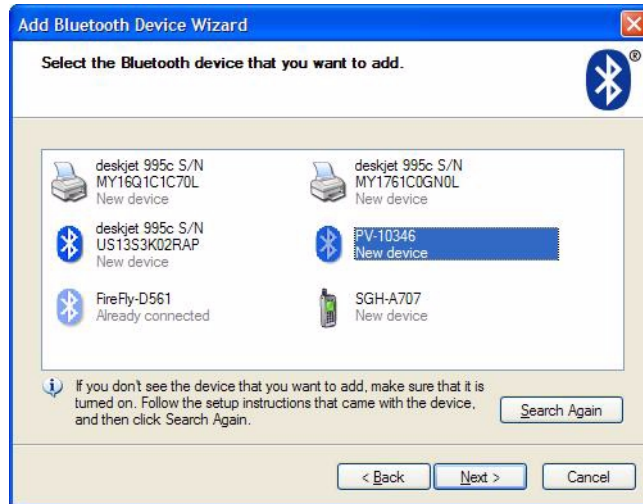

6. Select your whiteboard from the list and click “Next.” You see the dialog box shown below.

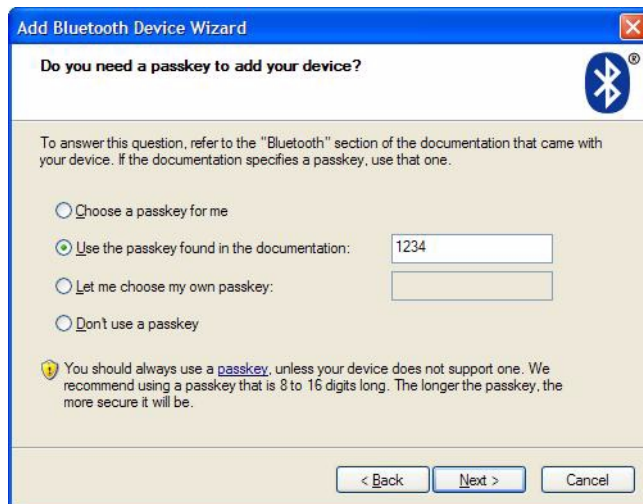

7. Click the radio button beside “Use the passkey found in the documentation” and enter “1234” as shown.

8. Click “Next” and wait for the software to connect to the whiteboard.
9. The software automatically finishes establishing the connection and tells you the COM port where you can expect to find the whiteboard connection. In the example below, the COM port is COM36.



10. Your whiteboard is now accessible via the Bluetooth connection.
11. This Bluetooth communication link appears in the list of active connections on your computer and automatically reconnects in the future.
12. To check or change this Bluetooth connection, choose “Open Bluetooth Settings” from the menu that appears when you right click the Bluetooth icon in your taskbar.
13. If the software asks you for a passkey, the factory default is “1234.”
14. Skip to “Confirming Bluetooth registration” on page 45.

Registering the whiteboard on a Macintosh

For each whiteboard that you want to share wireless Bluetooth communication with your computer, you must register the whiteboard with your computer.

1. To see the Bluetooth menu, click the Bluetooth icon in the system menu.

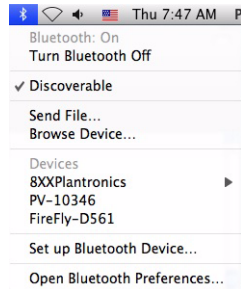

2. Select "Set up Bluetooth Device." The Bluetooth Setup Assistant appears.

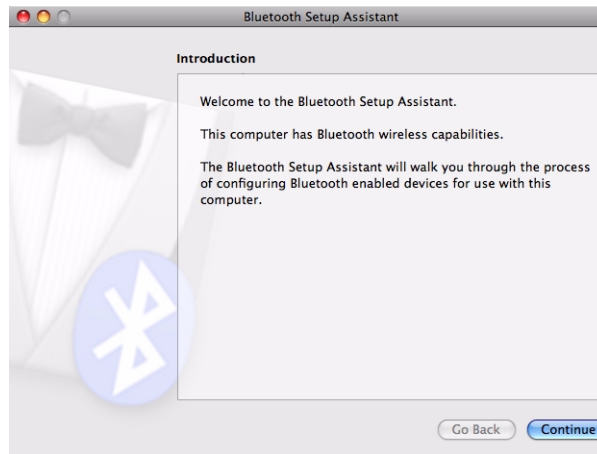

3. Click "Continue." You see the Select Device Type dialog.

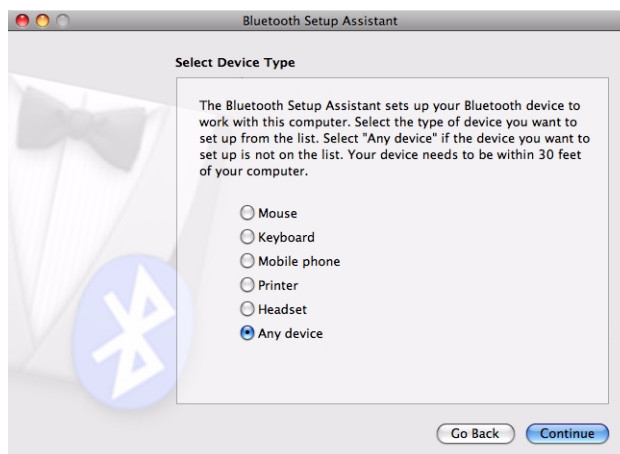

4. Select "Any device."
5. Click "Continue." A list of discoverable Bluetooth devices appears.

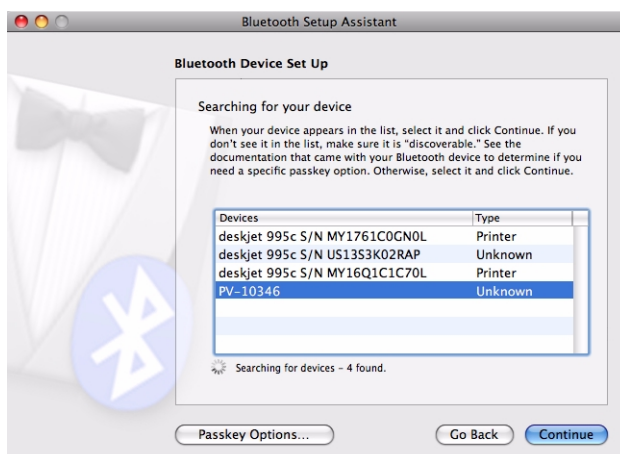

6. Select the Polyvision Bluetooth-Serial adapter identified by a number in the form PV-10346, for example.

7. Click "Continue." The system gathers information about your adapter.



8. Click "Continue" when the setup assistant has completed gathering information about your device. You are prompted to enter a passkey.

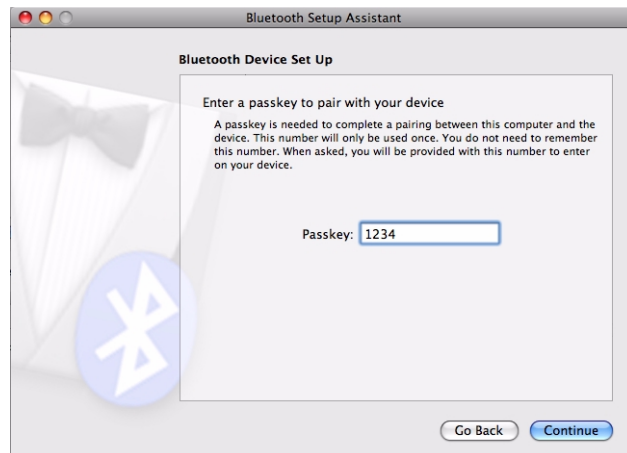

9. Enter "1234."

10. Click "Continue." You see the Bluetooth Device Setup window. No services are available.



11. Click "Continue." You see the Conclusion window.



12. Click "Quit."

Confirming Bluetooth registration

To confirm wireless communication between your computer and the whiteboard:

1. Click the PolyVision driver icon in your system tray (Windows) or system menu bar (Macintosh). You see the PolyVision driver menu.
2. Choose "Configure the PolyVision driver" from the menu.
3. Click the "Hardware" tab. Your Bluetooth device appears in the list using an identification number in the form "PV 10346" for example.

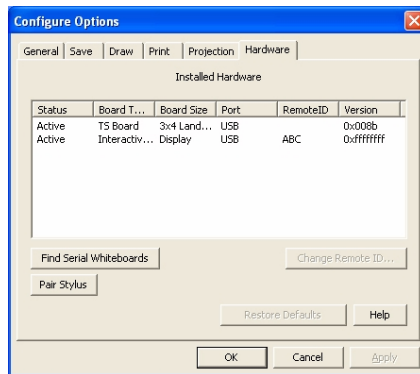

4. Some whiteboards may not be listed. If your device is not listed, click "Find Serial Whiteboard." If your device is still not listed, there is a problem with your Bluetooth registration.
5. Click "OK" to close.
6. Confirm that the whiteboard and your computer are communicating by writing on the board saving a sample file (Press "Save" on the remote control for WT or WTL or tap the "Save" icon on the whiteboard for TS 600). Check the file in your "My Documents" (Windows) or "Documents" (Macintosh) folder. You are finished!

FCC identification

The FCC identification number for this Bluetooth device is T9JRN41.

Technical support

If reviewing the above sections fails to resolve your hardware or driver problem, contact PolyVision North American Technical Support:

- Phone: 1.800.620.POLY (7659), 678.542.3100
Technical support representatives are available Monday through Friday from 8 AM Eastern time to 8 PM Eastern time.
- E-mail: support@polyvision.com
- Internet: www.polyvision.com

Or, outside North America contact PolyVision Europe/Asia Technical Support:

- Phone: +32 (0)89 32 31 30
- E-mail: business.center@polyvision.be
- Internet: www.polyvision.com

Index

A

- A/B/C switch on remote control 9
- alignment options 31
- Alignment Points 31
- alignment type 19

B

- basics
 - printing 16
- Bluetooth 32
 - ID number 45

C

- Change drawing cursor for left handed person 29
- Check for Updates 33
- click trigger 7
- clicking using the remote control 7, 22
- computer operation from a whiteboard 22
- configuration options 28, 36
- confirm wireless communication 45
- Cordless lectern 1
- cursor movement from a whiteboard 22
- Cursor/Pen 20

D

- desktop alert window
 - enable or disable 29
 - size 31
- Desktop alert window size 31
- double-clicking using the remote control 7, 22
- Draw options 30
- driver 26
 - installation 27
 - menus and options 28, 36
 - updates 33

E

- Enable automatically check for updates 29
- Enable desktop alert window 29
- Enable Per User Settings 29

- erasing

- erase all button 21
 - mark-ups 21

- Exit PolyVision driver 34

F

- file name 30
- Find Serial Whiteboards 32, 36
- find snapshot on computer 30
- Find Whiteboard 46

G

- get started
 - installing the driver 27
 - projecting your computer 18
 - using multiple products 9
 - using the wireless option 36

H

- Hardware options 31
- highlighter 21

I

- infrared light (wireless option)
 - reflecting from walls and ceiling 36
- ink color
 - button 20
 - in your snapshot 12, 13
 - options 23
- Installed Hardware 31
- installing the driver 27
- Interactive panel 1
- interactive whiteboard 1
- IR light 38

K

- keyboard
 - remote control button 25
 - using the on-screen keyboard 8, 25

L

- Lightning 1

M

- Make Sounds 29

- mark-up 20
 - getting started 20
 - pen style 21
 - pen styles 21
- menu options 28, 36
- mouse clicks 7
- multiple products
 - getting started 9
 - status 31

N

- name of snapshot file 30
- Next 22, 24

O

- Open Webster 34
- operating distance 36
- options 28, 31, 36
 - file location 30
 - file type 30
 - printer used 30
- overview
 - projecting and using computer 1, 2
 - save or print snapshot 1

P

- page up or page down 22
- palette of pen colors 21
- pen color 12, 13
- pen style 8, 21
 - for mark-up 21
- pen/cursor button 20
- Permanently-Mounted Projector 31
- PolyKey
 - for driver installation 27
- PolyVision menu 33
- Previous 22, 24
- print 24
 - options 30
 - remote control button 6
- Print To 30
- projecting your computer 7
- projection alignment
 - number of alignment points 31
 - options 31

- projection mode
 - entering 7
 - entering text 25
 - exiting 18
 - mark-up 20
 - moving the mouse 22
 - options 31
 - tools 8

R

- Red Button 31
- red pen
 - options 23
- registering
 - Windows 43
- registering BT
 - TS models 45
- remote control
 - A/B/C switch 9
 - carrying with lanyards 4
 - cursor/pen button 8, 20
 - erase all button 6, 21
 - holster 4
 - ink color button 6
 - keyboard button 8, 25
 - L and R buttons 7, 22
 - lost 33
 - maximum operating distance 4
 - next and previous buttons 22
 - pen style button 8, 21
 - previous and next buttons 7
 - print button 6
 - projection button 7
 - save button 6
 - table-top use 4
 - using on-screen version 33
 - using the touch pad 7
- Replay Strokes 31
- requirements 26
- reveal 23
 - reveal entire screen 24
- right-click 7, 22
 - on the board 22
 - using the remote 22

S

- save 24

- save button 6
- Save File As 30
- Save image size 30
- Save to Directory 30
- show on screen remote control 33
- snapshot 24
 - file location 30
 - file name 30
 - in projection mode 20, 24
 - printing 30
 - saving 30
 - saving or printing 6
- software
 - menus 28, 36
 - options 28, 36
 - requirements 26
- sounds 13, 14
 - turning on or off 29
- spotlight 23
 - drag to ellipse 23
 - enlarge or shrink 23
 - removing 23
- Start PolyVision driver 34
- Startup Pen Style 30
- stylus
 - using 20
- system requirements 26

T

- technical support 47
- testing the wireless connection 46
- text entry
 - in projection mode 25
- This 1
- touch pad
 - using 7
- transceiver
 - positioning 39
 - status lights 39
- transceiver positioning 38
- troubleshooting
 - wireless option 40, 41
- TS Interactive Whiteboard 2, 5
- TS Lightning Interactive Whiteboard 2
- TS whiteboard
 - erasing the board 13
 - writing on the board 13

TS Wireless 40

U

- uninstall PolyVision driver
 - Macintosh 35
 - Windows 34
- USB cable
 - connection 36
 - PolyKey 27
- using the on-screen keyboard 25

W

- Walk-and-Talk whiteboard
 - erasing the board 12, 14
 - writing on the board 12, 14
- Walk-and-Talk Wireless 36
- Webster 34
- wireless
 - ceiling height 38
 - link 39
 - maximum distance 38
 - obstructions 38
 - troubleshooting 40, 41
- wireless (infrared)
 - broken link 40
- wireless communication 38
- wireless option 36
 - with Lightning 36
- wireless transmitter
 - positioning 36
 - testing 37
- writing
 - beside projected computer 20
 - color on the board and in snapshots 12, 13
 - on the board 12, 13
 - over computer projections 20

